

SCHEDULE OF LAND USE			
LAND USE	Lot/Block Number	Units	Area (ha) (ac)
18.0m Wide Semi-Det. Res.	19-24, 28-34	26	
9.15m Wide Detached Res.	35-38, 43, 44, 47-48, 61-64, 67, 68, 71, 72, 75, 77, 80-82, 85-87	29	
10.0m Wide Detached Res.	1-11, 13-16, 18-21, 23-24, 26-27, 29-30, 32-34, 36-38, 40-42, 45-46, 49-50, 52-53, 55-56, 58-59, 62-63, 65-66, 69, 70, 73-75, 78-79, 81-84, 86-88, 91-94, 96-104	65	
11.3m Wide Detached Res.	6-8, 13-15, 25, 26, 40-42, 82, 83, 97-99	12	4.43
12.2m Wide Detached Res.	27, 50-57	7	
Custom Detached Res.	66	1	
Future Development	Blocks 125 & 126	0.08	0.2
Existing Residential	Block 127	0.09	0.2
Open Space	Block 128	0.14	0.3
Utility	Block 129	0.03	0.1
Road Widening	Blocks 130 & 131	0.15	0.4
0.3m Reserve	Blocks 132 to 136	<0.01	<0.1
Walkway	Block 137	0.04	0.1
Roads		1.82	4.5
<b>Total</b>		<b>140</b>	<b>6.78</b> <b>16.7</b>

S-C-2018-0003, ZBA2018-0014

# DRAFT PLAN OF SUBDIVISION

FOR PART OF LOT 27, CONCESSION 3  
FORMER TOWNSHIP OF DARLINGTON  
NOW BEING LOTS 1 TO 6, INCLUSIVE  
LOTS 12 TO 17, INCLUSIVE  
AND  
PART OF LOT 18 REGISTERED PLAN No. 634  
MUNICIPALITY OF CLARINGTON  
REGIONAL MUNICIPALITY OF DURHAM

**August 24, 2020**

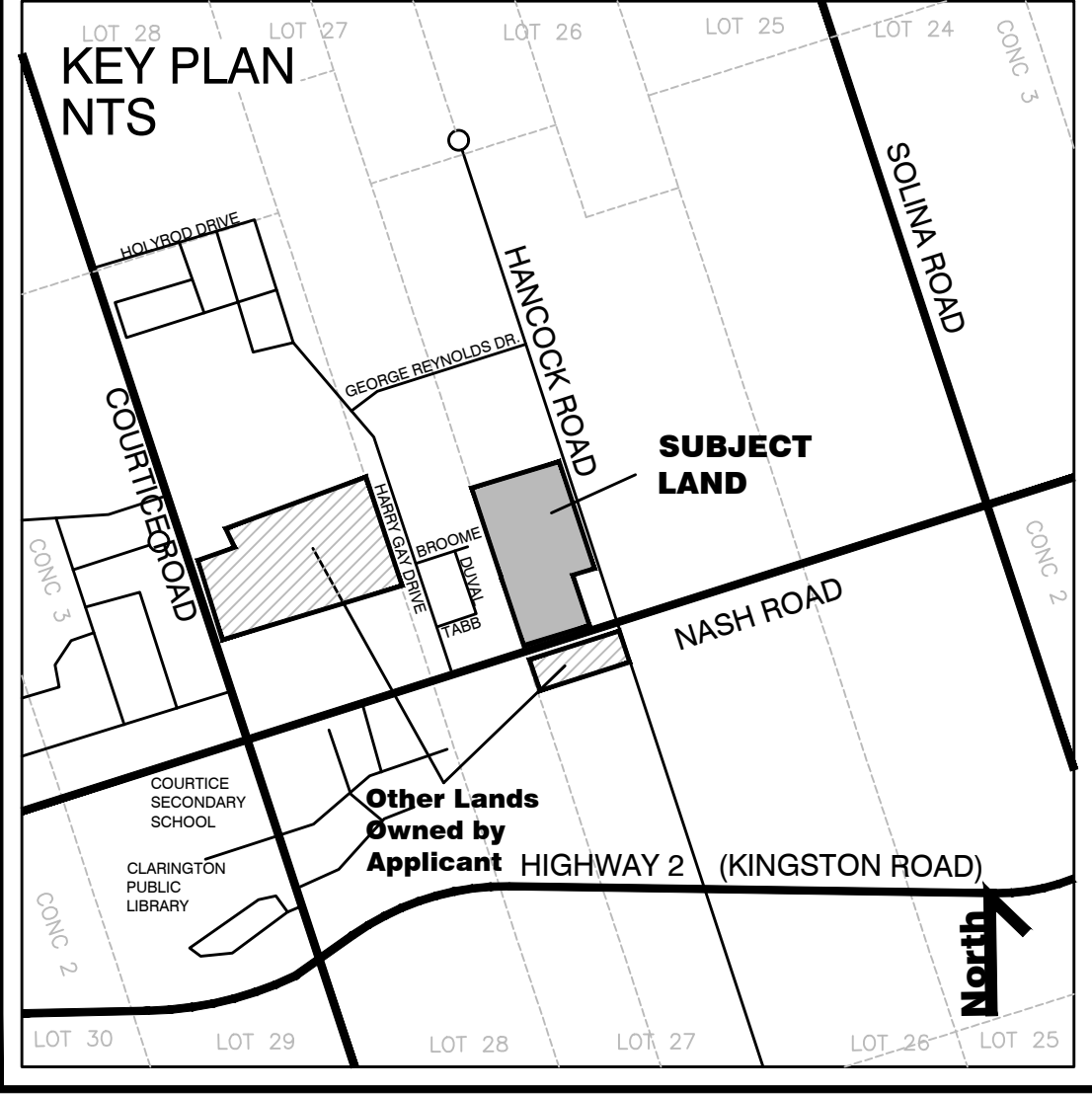

### ADDITIONAL INFORMATION REQUIRED UNDER SECTION 51 (17) OF THE PLANNING ACT, R.S.O., 1990

- (a) AS SHOWN ON DRAFT PLAN
- (b) AS SHOWN ON DRAFT AND KEY PLANS
- (c) AS SHOWN ON DRAFT AND KEY PLANS
- (d) THE LAND IS TO BE USED ACCORDING TO THE SCHEDULE OF LAND USE
- (e) AS SHOWN ON DRAFT AND KEY PLANS
- (f) AS SHOWN ON DRAFT PLAN
- (g) AS SHOWN ON DRAFT AND KEY PLANS
- (h) MUNICIPAL WATER SUPPLY TO BE MADE AVAILABLE
- (i) SOIL IS SILTY SAND
- (j) AS SHOWN ON DRAFT PLAN
- (k) FULL MUNICIPAL SERVICES TO BE MADE AVAILABLE
- (l) SUBJECT TO EASEMENTS AS SHOWN ON THE DRAFT PLAN

Notes:  
All dimensions on curves are chord lengths unless otherwise indicated.  
Dashed lines representing adjacent future development are conceptual only.  
Dashed lines representing 0.3m Reserves are exaggerated to illustrate location of reserve.

Scale 1 : 750  
(24 x 36)

### OWNER'S AUTHORIZATION

I AUTHORIZE THIS DRAFT PLAN OF SUBDIVISION TO BE SUBMITTED TO THE MUNICIPALITY OF CLARINGTON FOR APPROVAL.

SEE ORIGINAL FOR SIGNATURE \_\_\_\_\_ DATE \_\_\_\_\_  
Peter Cohen, President  
By Courtie Inc.

### SURVEYOR'S CERTIFICATE

I HEREBY CERTIFY THAT THE BOUNDARIES OF THE LAND TO BE SUBDIVIDED AS SHOWN ON THIS PLAN AND THEIR RELATIONSHIP TO THE ADJACENT LANDS ARE ACCURATELY AND CORRECTLY SHOWN.

SEE ORIGINAL FOR SIGNATURE \_\_\_\_\_ DATE \_\_\_\_\_  
R. Mc Roe, O.L.S.  
J. D. Barnes Limited

PLAN PREPARED BY  
**wsp**

18M-00161-00